

IMPORTANT VIGTIGT TÄRKEÄÄ VIKTIG VIKTIGT ВАЖНО ТЯНТИС ВАЖЛИВО SVARIGI SVARBU

2 Reset / Nulstil / Nollaus / Nullstill / återställ / Сброс / Lästestamine / Сброс / Atestate / Nustatyti is naujo 15.32 → 0.00

3 Setting menu / Indstillingsmenu / Asetusvalikko / Innstillingsmeny / Inställningsmenyn / Меню настроек / Seadistusmenüü / Меню налаштувань / Iestatījumu izvēlnē / Nustatymy menu

4 Exit Setting Menu / Luk indstillingsmenu / Poistu asetusalikosta / Avslutt innstillingsmeny / Lämnä inställningsmenyn / Выход из меню настроек / Välju seadistusmenüüst / Вийдіть із меню налаштувань / Iziet no iestatījumu izvēlnes / Ieisi iti nustatymy menu

Table with 4 columns: EN, DK, FI, NO, SE, RU, EE, UA, LV, LT. Each row lists the corresponding function name and a brief description of the feature in that language.

5 Set wheel size / Indstil hjulstørrelse / Aseta pyöräköko / Still hjulstørrelse / Ange hjulstorlek / Задать размер колеса / Määra rehviuurus / Налаштувати розмір колеса / Iestatīt riteņu izmēru / Nustatyto rato dydi

6 Set Unit of Measurement / Indstil måleenhed / Aseta yksikkö / Still måleenhet / Ange måttenhet / Задать единицы измерения / Määra mõõtühik / Налаштувати одиниці вимірювання / Iestatīt mērvienību sistēmu / Nustatyti matavimo vienetus

7 Set total distance / Indstil samlet distance / Aseta kokonaismatka / Still totaldistans / Ange totalt avstånd / Задать общий пробег / Määra kogu läbitud vahemaa / Налаштувати загальну відстань / Iestatīt kopējio attālumu / Nustatyti visą atstumą

8 Set clock / Indstil ur / Aseta kellonaika / Still klokke / Still in Klockan / Настроить часы / Määra kellaaeg / Налаштувати годинник / Iestatīt pulksteni / Nustatyti laikrodį

9 Set scan mode, on/off / Slå scan-modus til/ Fra / Käynnistä/sammuta hakutila / Still skannemodus, på/av / Ange skanningsläge, på/av / Задать режим сканирования, вкл./выкл. / Määra skannimisrežiimi, sees/väljas / Налаштувати режим сканування, увімк./вимк. / Iestatīt skenēšanas režīmu, ieslēgts/izslēgts / Nustatyti nuskaitymo režimą, įjungti / išjungti

Start-up, Troubleshooting, Warranty, Technical data, PC interface, Important tips in multiple languages (EN, DK, FI, NO, SE, RU, EE, UA, LV, LT) covering user guides, troubleshooting steps, warranty details, and technical specifications.

EN, DK, FI, NO, SE, RU, EE, UA, LV, LT. Additional language versions of the troubleshooting and warranty sections.

SE, EN. Swedish and English versions of the troubleshooting and warranty sections.

SE, EN. Swedish and English versions of the additional troubleshooting and warranty information.



Battery installed / Batteri installeret / Paristo asennettuna / Batteri installeret / Batteri installeret / Установленная АКБ / Patarei paigaldatud / Установлена аккумуляторная батарея / Bateriaja ir ievietota / Bateriaja jēdta

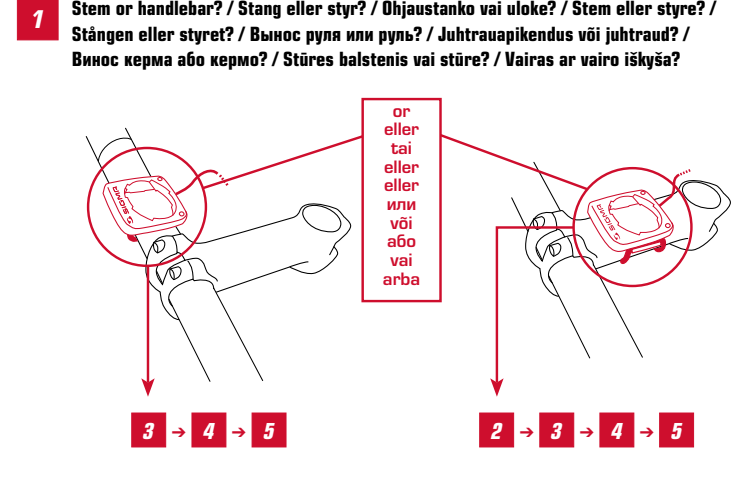

3 → 4 → 5

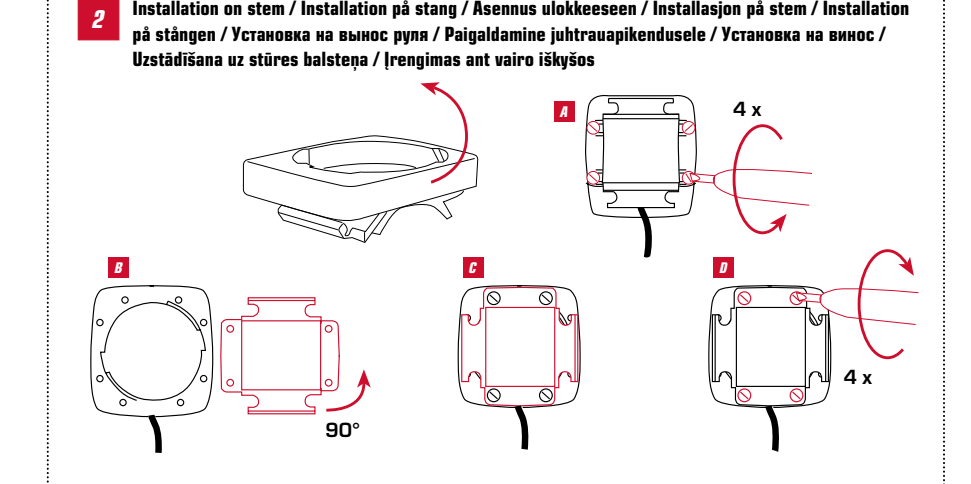

1 2 3 4



1 2 3 4

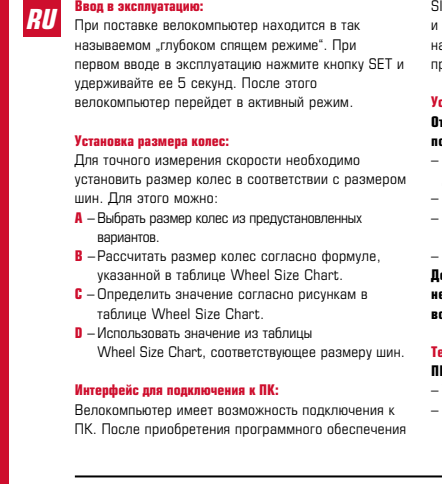

1 2 3 4

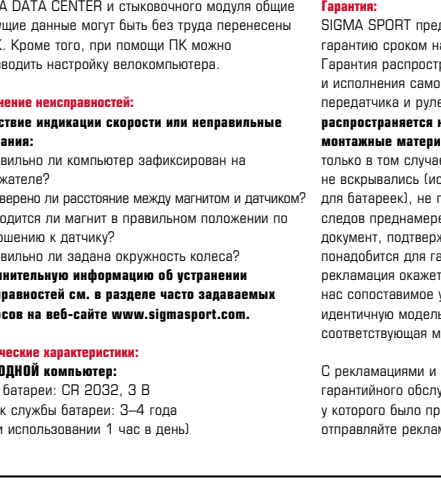

1 2 3 4

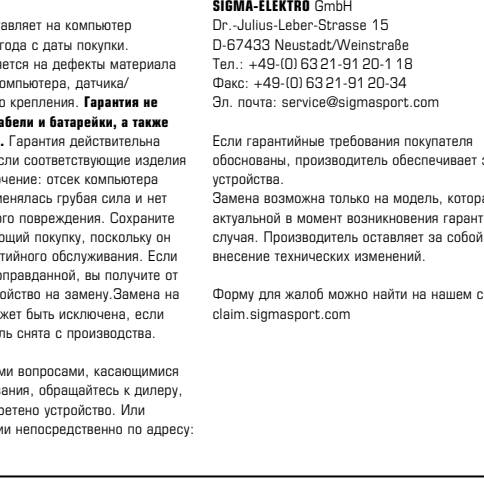

1 2 3 4



4 A

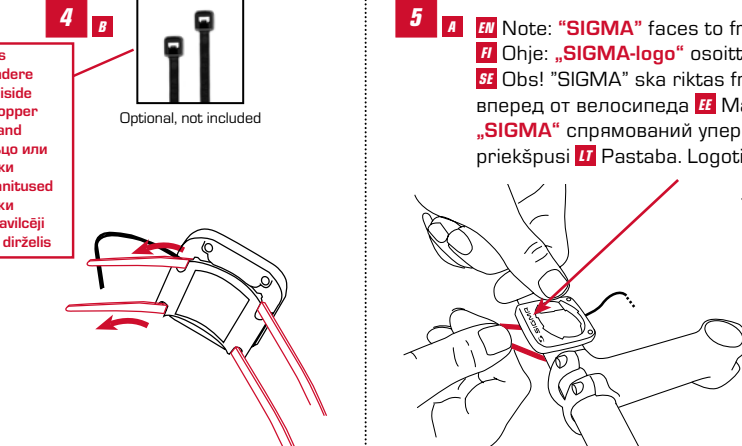

4 B



5 A

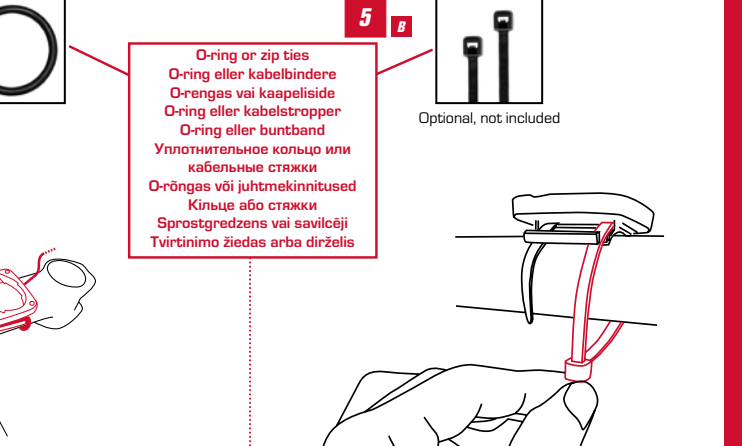

5 B



5 C

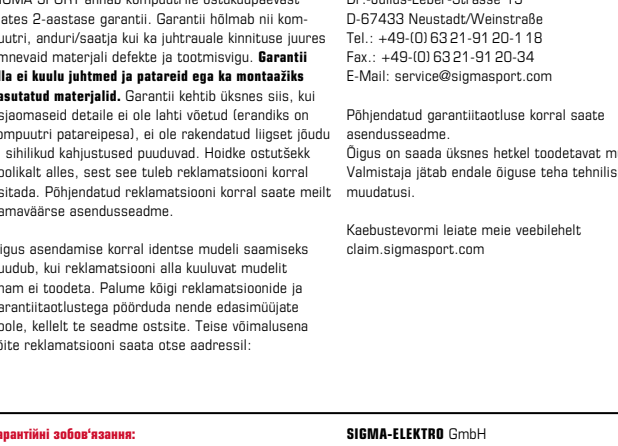

5 D

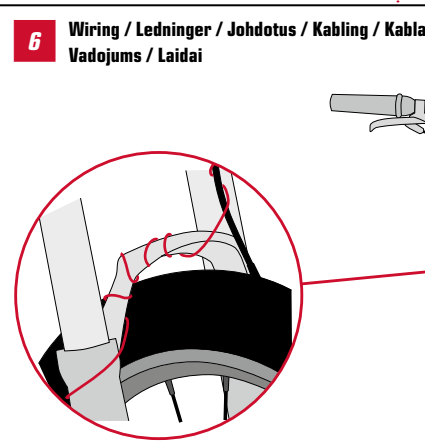

6 A

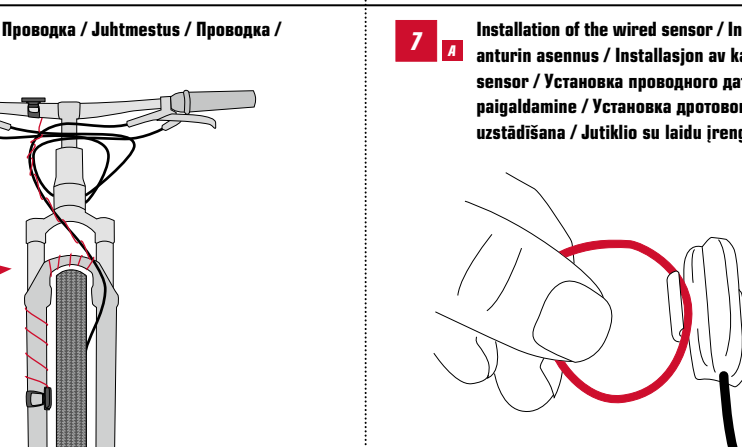

6 B

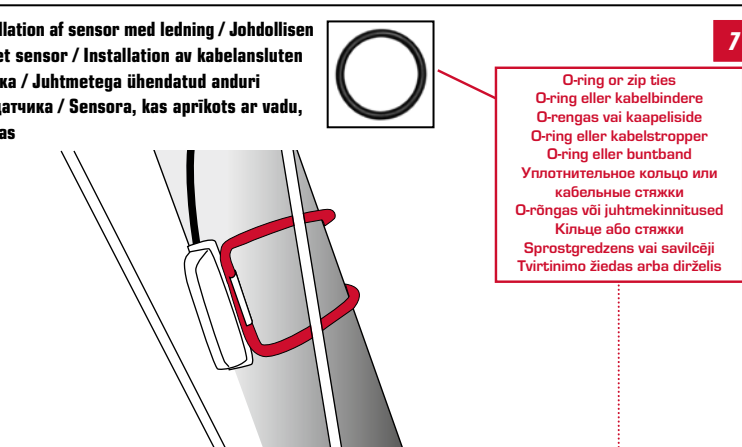

7 A

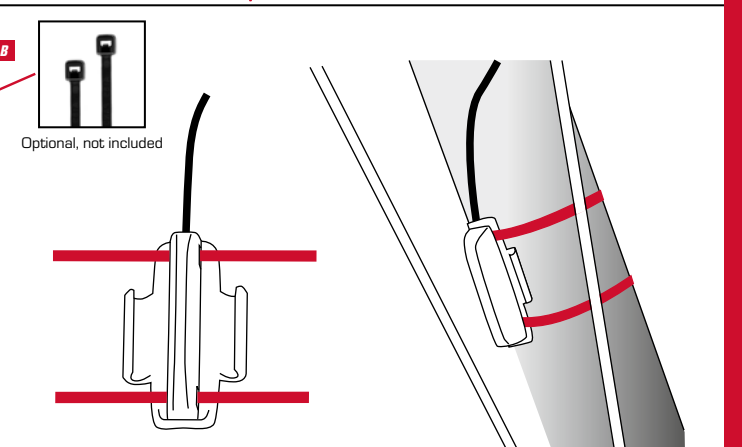

7 B

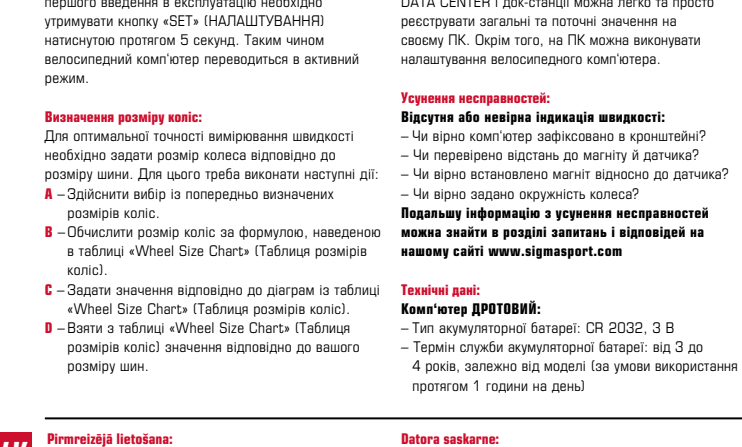

7 C

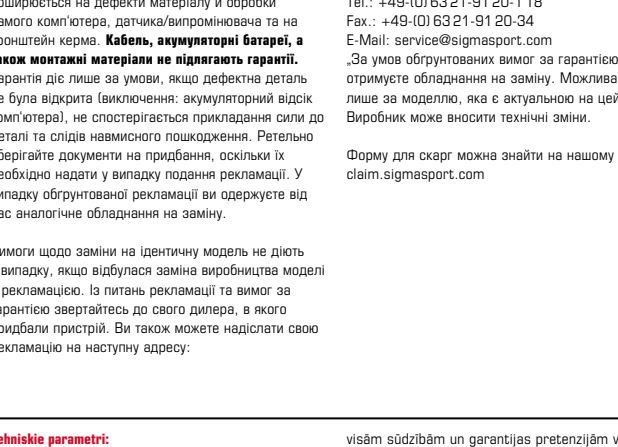

7 D

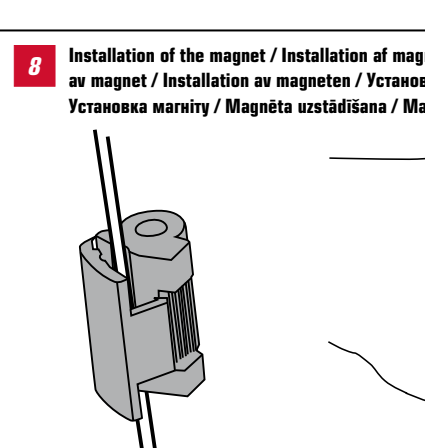

8 A

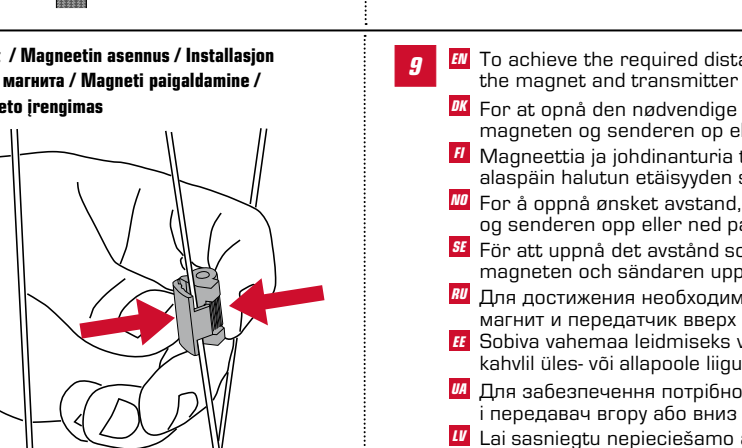

8 B

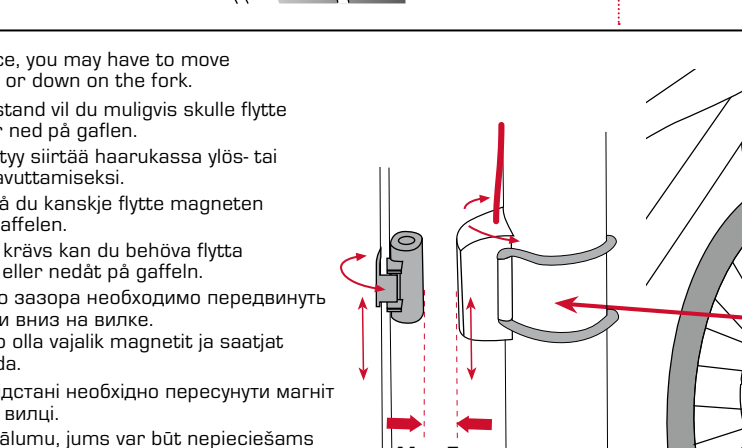

9 A

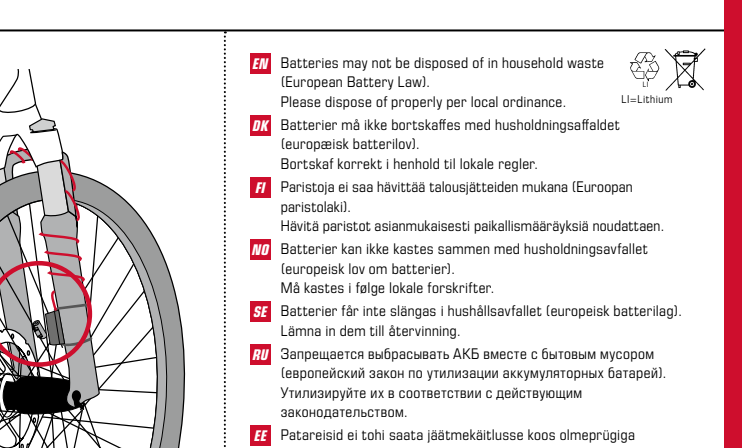

9 B

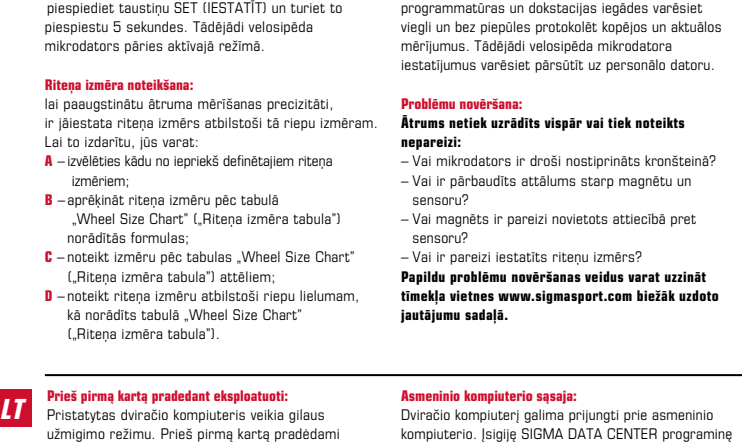

9 C

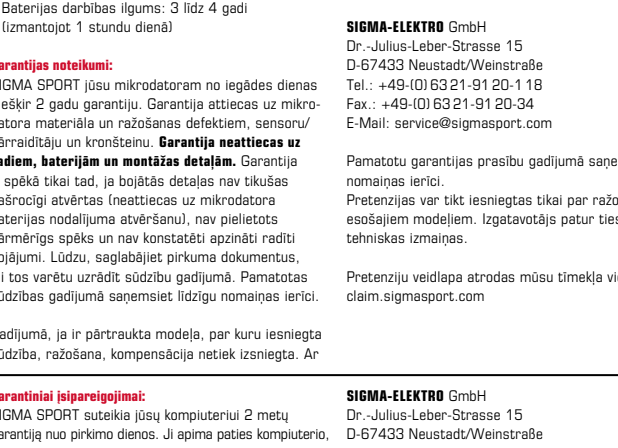

9 D

Table with 3 columns: Wheel size (mm), Wheel size (inch), and Wheel size (mm). Rows include 16", 18", 20", 22", 24", 26", 27", 27.5", 28", 29", 700C.

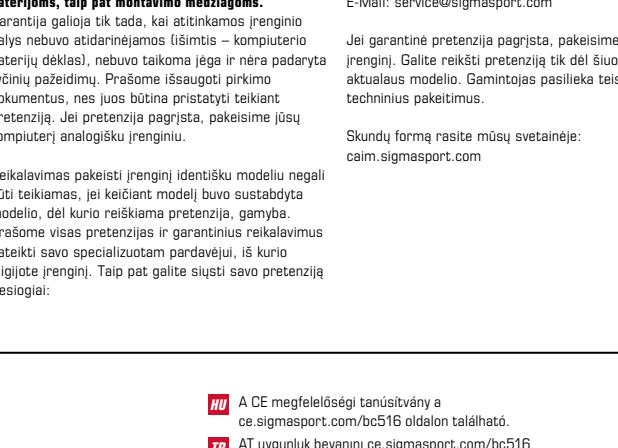
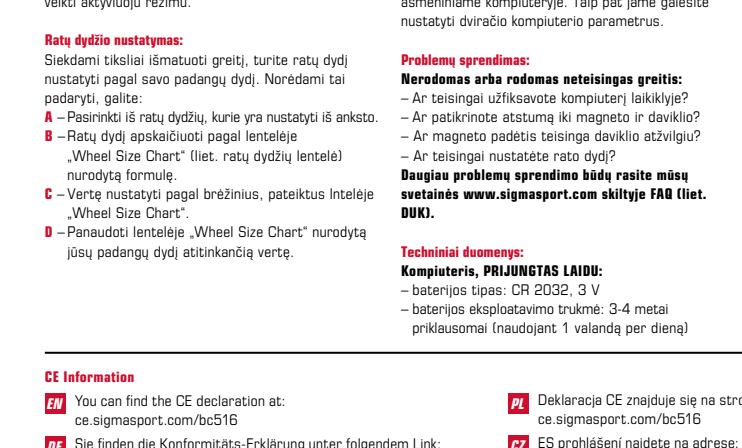
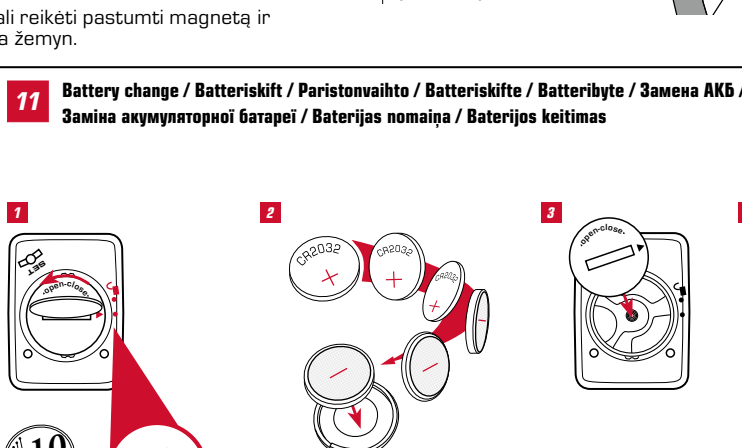
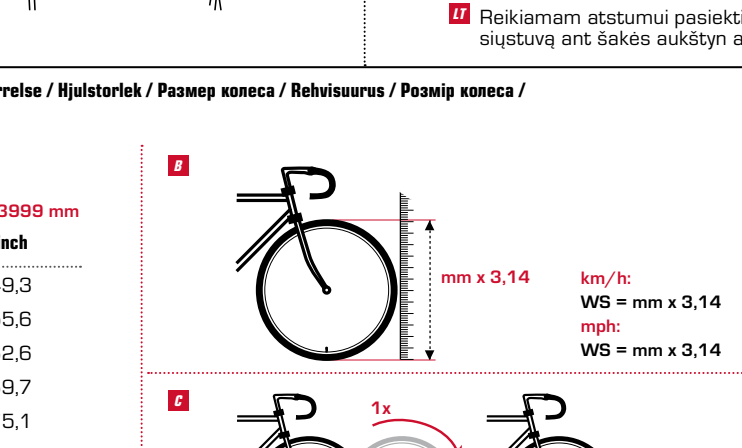

Table with 3 columns: Wheel size (mm), Wheel size (inch), and Wheel size (mm). Rows include 16", 18", 20", 22", 24", 26", 27", 27.5", 28", 29", 700C.

